

SEPTEMBER 2021

THE BULLDOG BULLETIN

Updates for the Westview Elementary Community



Principal's Corner

Hello Westview Families,

Our staff is ready to welcome you all to the new school year. The classrooms are set up to create a community of learners, the lunchroom is ready for our meals and lockers and desks labeled for your child. We appreciate that most of you were able to facilitate the 1:1 meeting between your child and the teacher and help us get paperwork completed. We will assure all students are assessed and paperwork will be sent home if you weren't able to make it.

We will continue to have safe, healthy practices for our school community by all wearing masks while indoors, washing hands, sanitizing each evening and a Hepa filter in each room. Students will also need to wear a mask on the bus. At this time, we are also limiting visitors into the building so you will not be able to walk your child to their rooms or join us for lunch. There will be some situations where volunteers can support teachers for a limited time. We appreciate your support in all these efforts.

We will be using a pick-up process at the end of the day for families who drive their children to school. Staff will use your household number you received with your child's paperwork during assessments or that will be brought home on the first day of school to dismiss your child from class as you arrive into the parking lot. You can put the paper in the right hand side dashboard space for us to easily see. Don't worry if you don't have it on the first day,

I am excited for the new year to have our students back and welcome all who are new to us. Feel free to reach out at anytime with questions or feedback.

Tami Staloch-Schultz, principal

IN THIS ISSUE:

- District Updates
- Student Drop-Off/Pick-Up Information
- Teacher & Staff Highlights
- PTO Happenings

Family Engagement

Westview is an All-School Title 1 school. We get additional funds to help support differentiation in all the classrooms for math and literacy. Family engagement is a big part of the title program. We would like to make our Family Engagement Plan for the 2021-2022 year in September. We will meet at Westview (or we can meet on zoom)- the time can be flexible. If you are interested in helping brainstorm ideas for this year, please contact Stephanie Nord stephanie.nord@district196.org.

Masks Required on Buses & Inside Schools

State officials have given school districts the responsibility to determine COVID-19 mitigation strategies at the local level this school year. The 2021-22 COVID-19 Operational Plan that was unanimously approved by our School Board on August 26 requires all students, staff and visitors in all District 196 buildings to wear a face mask indoors when the local transmission level is “substantial” or “high” as measured by the CDC transmission matrix. Currently, the transmission level in Dakota County is high, meaning face masks will be required in our schools to start the year, just as they are required to enter a growing number of businesses, government buildings and on all public transportation and airline flights.

Your partnership is critical to the success of our students. We expect students, staff and visitors to comply with the mask requirement until the COVID-19 spread in Dakota County drops to the “moderate” level of transmission. Masks help reduce spread and give us the best opportunity to provide in-person education all year. Just like last year, students will have opportunities for mask breaks during the day, such as at lunch or while outside. Medical exemptions will be allowed with confirmation from a health professional. If parents and guardians are concerned about their child’s ability to safely wear a mask, school staff will partner with families to determine alternative options, build skills and layer mitigation strategies to protect the learning community.

Our district is committed to doing all we can to ensure students can continue learning in person this school year. This includes HEPA filters in all learning spaces, social distancing, recommending COVID-19 vaccinations for those who are eligible to receive them, and requiring masks when the local transmission level is substantial or high.



Here Comes the Bus

At the beginning of the 2019-20 school year, District 196 parents whose children ride the bus to and from school each day will be able to track the location of their child's bus using the smartphone application "Here Comes the Bus."

With Here Comes The Bus, parents are able to set up a perimeter around their child's bus stop. When their child's bus enters that perimeter, the app sends an alert. Here Comes The Bus also sends notification messages if a bus is running late or if a different bus has been substituted for a child's usual bus. The app uses HTTPS, or Hypertext Transfer Protocol Secure, which encrypts all communication between the web browser and the app for security. The app tracks district buses using GPS; it does not track students.

Setting up the app

The Here Comes The Bus app is available to download free on the **Google Play Store** for Android and **App Store** for iPhone.

To set up an account, parents will need a school identification number and their child's lunch account number. Parents will be able to monitor buses for multiple children from a single account. Schools will share setup instructions and school identification numbers with parents. If you did not receive it, ask your child's school.

- Log into the app with your email address and use the District 196 ID: 73500
- Add your student's name and student lunch account number, which can be found in their Infinite Campus profile. (If your child is in Early Childhood Education, contact the Transportation to get a temporary lunch account number. Email Transportation@district196.org.)
- Once login is complete, set up a virtual radius that will alert when the bus is in the area.



Student Drop-Off/Pickup Information

By Gwen Krueger

Students who get dropped off or picked up from school, will use the front parking lot perimeter only. It is not safe to drop your child off in the parked car areas. Vehicles can load/unload anywhere along the yellow curb. All families will receive a paper indicating a household number during the summer assessment days. For after school pick up, please display this number on the right hand side of your dashboard / windshield. This will allow us to enter the numbers into an app which will quickly notify the classroom teacher to release your child (ren) from class. Always pull up as far as you can along the yellow curb. Please be patient during these times since we have many students who still need assistance getting in and out of a car seat or require hand-to-hand adult support. Big buses will load and unload along Garden View Drive. Small buses will use the north drop off area.

Featured Teacher: Megan Weatherly

By Nicole Gorman

Each month the Bulldog Bulletin will highlight a teacher and/or staff member for the Westview Community to get to know better. September is highlighting Megan Weatherly, Strategies Classroom.

When asked what three words describe her, she responded with "optimistic, good sense of humor and welcoming."

Some of Megan's favorite things include being with family and friends, walking her fur babies, reading, Starbucks and Target runs, watching hockey and enjoying the sunshine! I then asked her to tell me something about herself. Megan said, "I was married last year in June during COVID and am keeping my maiden name for teaching. My husband and I went to grade school together where his mom was a teacher. I have a picture of us from our kindergarten days." Lastly, one surprising fact about Megan is that she read all of the Harry Potter books for the first time this summer. Welcome to Westview, Megan!



Teacher & Staff Highlights



Welcome New Teachers & Staff:

- Megan Weatherly, Strategies Classroom
- Brooke Raske, Long Term Sub for Courtney Crist
- Lily Ferreira, Social Worker
- Kaley Isaacson, Art Teacher
- Rachel Brintnall, Secretary
- Lizzy Bouts, Media Clerk
- Hey-Jeong Thompson, Pre-School Teacher
- Anna Zbarouskaya, 4th Grade
- Christina Pillow, Resource Teacher
- Christy Davis, Math Coach

- Keri Flaskerud, Reading Recovery
- Sada McGrath, Reading Recovery

Teacher & Staff Changes:

- Brittany Flaherty, 2nd Grade
- Sarah Schur, Kindergarten
- Lauren Schweich, 3rd Grade
- Felicia Holbrook, 1st Grade
- Chaka Tobias, 2nd Grade
- Whitney Zahn, 4th Grade
- Kirsten Kissel is now Kirsten Overson

THE WESTVIEW PTO WELCOMES YOU!

WHY WE EXIST

Westview Elementary PTO is a non-profit organization committed to providing the best educational and social experience for Westview students and families. We believe we are stronger together and exist to provide volunteer services and funds that help support student educational efforts and activities. As a Westview parent or guardian, you are already part of PTO!

WHAT WE SUPPORT



EQUIPMENT

Purchase items including iPads; computers; and outdoor learning, playground, and landscaping/garden equipment.



STUDENT LEARNING & EVENTS

Fund and staff student events (Bulldog Bingo and Art Adventures), the student kindness initiative, and a \$1K scholarship for former students.



FIELD TRIPS

Provides partial funding for transportation and admission costs.



BOOK FAIRS

Organize and staff biannual book fairs with profits supporting the Westview library.



STAFF APPRECIATION

Give back to our hard working Westview staff by donating meals, supplies, and organizing the Giving Tree.

FUNDING SOURCES

Direct Donations | Butterbraid Sale | APEX Fun Run | Penny Wars | Dine-n-Donate | Spring Carnival | Box Tops for Education

FOLLOW US



[WWW.FACEBOOK.COM/WESTVIEWMNPTO](https://www.facebook.com/westviewmnpto)



[@WESTVIEWMNPTO](https://www.instagram.com/westviewmnpto)

JOIN US

HELP US PROVIDE THE BEST FOR OUR KIDS!

🐾 SUPPORT FUNDRAISING EFFORTS

🐾 VOLUNTEER AT AN EVENT

🐾 JOIN US AT A PTO MEETING 2021-2022 Schedule: Sept. 20, Oct. 18, Jan. 24, March 14, May 16

Westview PTO Thanks All Involved in the Outdoor Learning Center

By Melissa Wikstrom

Thanks to the support of our Bulldog community, we raised over \$10,000 for our Outdoor Learning Fundraiser! A committee is currently working with a landscape company to discuss plans for a dedicated outdoor classroom that will include individual seating and native plants. We have also started refreshing the Science Court for additional learning opportunities. Stay tuned for more updates!

August 30 Update:

Phase 1 of the Science Court update is complete! Thank you to Ms. Nord and her family for dedicating their Sunday to planting and mulching and to Eisele Greenhouse for donating 20 plants. Plants were selected that will bloom in the spring and fall when school is in session so our Bulldogs have plenty of botanical learning opportunities!

August 26 Update:

Thank you to the Doepke, Nguyen and Siedel families for donating and transporting materials for our Outdoor Learning area!



Makes lessons more enjoyable

Students feel happier and healthier

Improves social skills

Enhances memory

Increases motivation

Positive impact on student behavior

Improves teachers' health & wellbeing

Decreases stress levels

Supplements STEAM lessons

(science, technology, engineering, art & math)

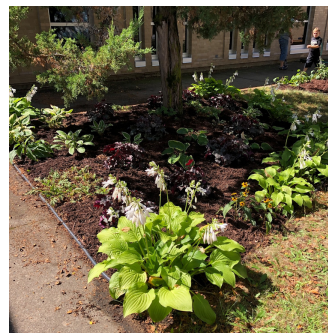

Appreciation of Staff & Teachers



It's a treat to have such amazing Westview staff! The PTO is happy to provide some snacks as our Bulldog staff returns for workshops.

PTO Highlights:

Join us in-person for our first PTO meeting of the school year on **MONDAY, SEPTEMBER 20th**, from 6-7 pm at Westview! Learn more about what we do, what we support, upcoming events, and how you can be involved!

Future meetings (in-person or virtual) : October 18, January 24, 2022, March 14, 2022 & May 16, 2022; 6-7 p.m.

In Search Of:

Leaders and Co-Leaders with Grants/Donations, Treasurer, Yearbook and First Grade Books. Time commitment varies from a few hours a month to a few hours a season, and can be shared with a friend! For more information contact Michelle Doepke at mruckmar@yahoo.com.



2021-22 School Year Calendar

JULY 2021						
S	M	T	W	T	F	S
				1	2	3
4	5	6	7	8	9	10
11	12	13	14	15	16	17
18	19	20	21	22	23	24
25	26	27	28	29	30	31

SEPTEMBER 2021						
S	M	T	W	T	F	S
			1	2	3	4
5	6	7	8	9	10	11
12	13	14	15	16	17	18
19	20	21	22	23	24	25
26	27	28	29	30		

NOVEMBER 2021						
S	M	T	W	T	F	S
	1	2	3	4	5	6
7	8	9	10	11	12	13
14	15	16	17	18	19	20
21	22	23	24	25	26	27
28	29	30				

JANUARY 2022						
S	M	T	W	T	F	S
						1
2	3	4	5	6	7	8
9	10	11	12	13	14	15
16	17	18	19	20	21	22
23	24	25	26	27	28	29
30	31					

MARCH 2022						
S	M	T	W	T	F	S
		1	2	3	4	5
6	7	8	9	10	11	12
13	14	15	16	17	18	19
20	21	22	23	24	25	26
27	28	29	30	31		

MAY 2022						
S	M	T	W	T	F	S
1	2	3	4	5	6	7
8	9	10	11	12	13	14
15	16	17	18	19	20	21
22	23	24	25	26	27	28
29	30	31				

AUGUST 2021						
S	M	T	W	T	F	S
1	2	3	4	5	6	7
8	9	10	11	12	13	14
15	16	17	18	19	20	21
22	23	24	25	26	27	28
29	30	31				

OCTOBER 2021						
S	M	T	W	T	F	S
					1	2
3	4	5	6	7	8	9
10	11	12	13	14	15	16
17	18	19	20	21	22	23
24	25	26	27	28	29	30
31						

DECEMBER 2021						
S	M	T	W	T	F	S
			1	2	3	4
5	6	7	8	9	10	11
12	13	14	15	16	17	18
19	20	21	22	23	24	25
26	27	28	29	30	31	

FEBRUARY 2022						
S	M	T	W	T	F	S
		1	2	3	4	5
6	7	8	9	10	11	12
13	14	15	16	17	18	19
20	21	22	23	24	25	26
27	28					

APRIL 2022						
S	M	T	W	T	F	S
					1	2
3	4	5	6	7	8	9
10	11	12	13	14	15	16
17	18	19	20	21	22	23
24	25	26	27	28	29	30

JUNE 2022						
S	M	T	W	T	F	S
			1	2	3	4
5	6	7	8	9	10	11
12	13	14	15	16	17	18
19	20	21	22	23	24	25
26	27	28	29	30		

Start and End Dates	
Aug. 30-31	Kindergarten transition days (half days, K only)
Sept. 1-2	Student assessments (elementary) First days of school grades 6-12 (Student Success Days)
Sept. 8	Regular classes begin for grades 1-12
Sept. 9	Regular classes begin for kindergarten
June 8	Last day of school

No-School Dates		
	= No school for all students	= No school for some students

Oct. 1	High school data analysis/instruct alignment (no school grades 9-12)
Oct. 8	Elementary and middle school data analysis/instruct alignment and high school conferences (no school grades K-12)
Oct. 21-22	State teachers' convention (no school grades K-12)
Nov. 4	Conferences for elementary and middle schools (no school grades K-8)
Nov. 5	Staff development for high school staff (no school grades K-12)
Nov. 25-26	Thanksgiving break (no school grades K-12)
Dec. 2	End of first trimester
Dec. 3	Staff development for all staff (no school grades K-12)
Dec. 24-Jan. 1	Winter break (no school grades K-12)
Jan. 14	Data analysis day for high school staff (no school grades 9-12)
Jan. 17	Martin Luther King Day (no school grades K-12)
Jan. 21	Data analysis day for elementary and middle school staff, and high school conferences (no school grades K-12)
Feb. 10	Conferences for elementary and middle schools (no school grades K-8)
Feb. 11	Staff development for high school staff (no school grades K-12)
Feb. 21	Presidents' Day (no school grades K-12)
March 10	End of second trimester
March 11	Staff development for all staff (no school grades K-12)
March 21-25	Spring break (no school grades K-12)
April 22	Data analysis day for all staff (no school grades K-12)
May 30	Memorial Day (no school grades K-12)
June 8	Last day of school (End of third trimester)

Other Dates for Employees	
Aug. 23-24	New teacher workshop
Aug. 25-31	Teacher workshop K-12 (half day on Aug. 27)
June 9	Staff workshop (half day)